

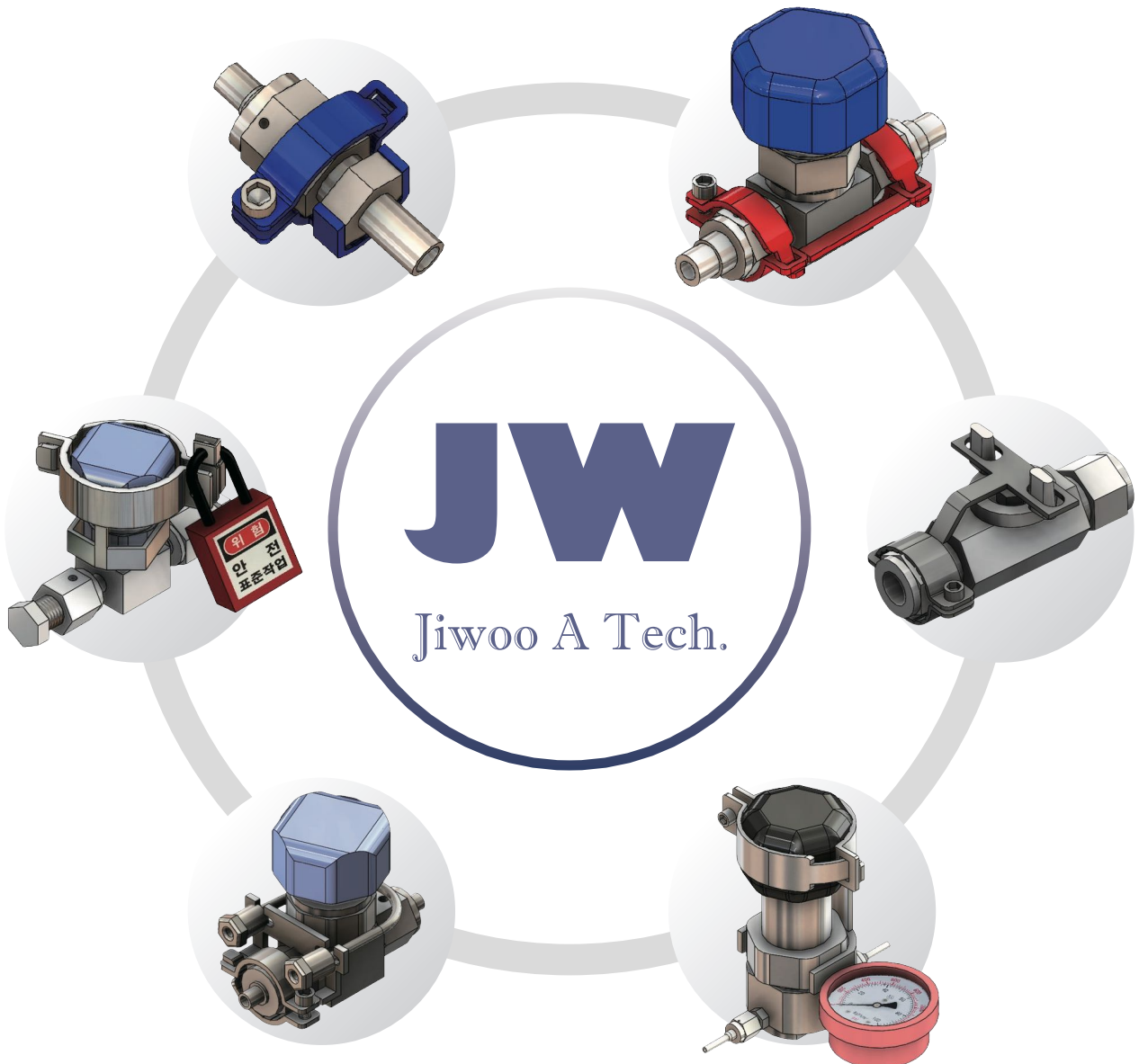

지 우 락 디 바 이 스

Lock Device for Fittings & Valves



FEATURES

Patent



Patent # : 10-1916699

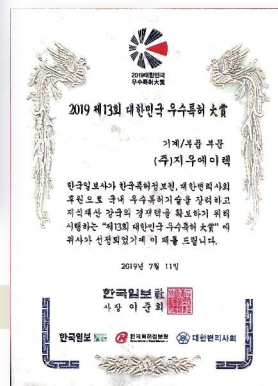

2019 Patent Awards

Mechanism

Tightening the male & female nut

피메일 너트와 메일 너트를 단단히 고정



Colorize

Can distinguish
by gas types
in toxic gas line

독성 가스 라인에
가스 종류별 구분 가능

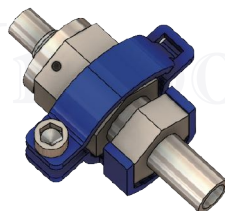

Can divide
supply or return line

Supply / Return 등
라인별 구분 가능

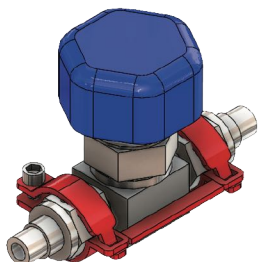

Lock Out, Tag Out

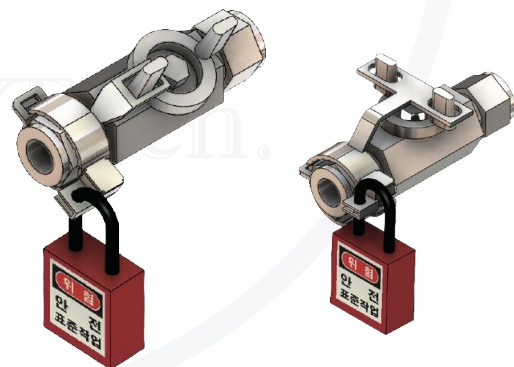

Possible to verify that
valves are properly locked and may not operate
until safety is ensured

LOTO 절차는 밸브가 적절하게 잠겼는지,
안전이 확보될때 까지 작동하지 않을 수 있는지
확인이 가능하게 해줍니다.

Youtube Clip
How to Install
Jiwoo Lock Device



PRODUCTS

Lock Devices for Fittings

Metal Face Seal Straight Assembly

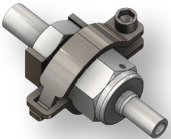
	Size	Part Number
	1/8"	SS-LDS-FR2-
	1/4"	SS-LDS-FR4-
	3/8", 1/2"	SS-LDS-FR8-
	3/4"	SS-LDS-FR12-
	1"	SS-LDS-FR16-

Metal Face Seal Bulkhead

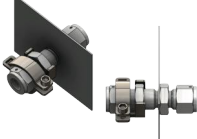
	Size	Part Number
	1/4"	SS-LDBU-FR4-
	3/8", 1/2"	SS-LDBU-FR8-
	3/4"	SS-LDBU-FR12-
	1"	SS-LDBU-FR16-

Tube Cap

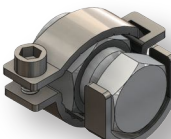
	Size	Part Number
	1/4"	SS-LDTC-FL4
	3/8"	SS-LDTC-FL6
	1/2"	SS-LDTC-FL8
	3/4"	SS-LDTC-FL12
	1"	SS-LDTC-FL12

Union

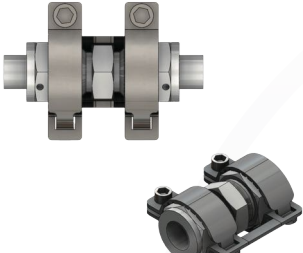
	Part Number		Size	Type
	SS-LDU-	FR4-	1/4"	Metal Face Seal
		FR8-	3/8", 1/2"	
		FR12-	3/4"	
		FR16-	1"	
	SS-LDU-	FL4	1/4"	General Tube Fitting
		FL6	3/8"	
		FL8	1/2"	
		FL12	3/4"	
		FL16	1"	

Union Elbow

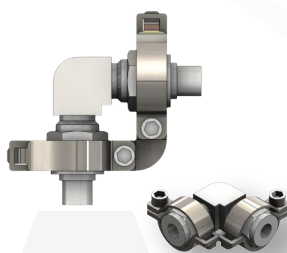
	Part Number		Size	Type
	SS-LDE-	FR4-	1/4"	Metal Face Seal
		FR8-	3/8", 1/2"	
		FR12-	3/4"	
		FR16-	1"	
	SS-LDE-	FL4	1/4"	General Tube Fitting
		FL6	3/8"	
		FL8	1/2"	
		FL12	3/4"	
		FL16	1"	

Union Tee

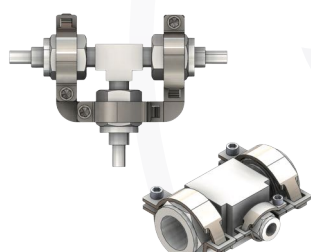
	Part Number		Size	Type
	SS-LDT-	FR4-	1/4"	Metal Face Seal
		FR8-	3/8", 1/2"	
		FR12-	3/4"	
		FR16-	1"	
	SS-LDT-	FL4	1/4"	General Tube Fitting
		FL6	3/8"	
		FL8	1/2"	
		FL12	3/4"	
		FL16	1"	

Union Cross

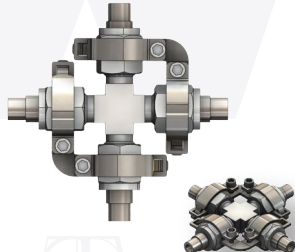
	Part Number		Size	Type
	SS-LDC-	FR4-	1/4"	Metal Face Seal
		FR8-	3/8", 1/2"	
		FR12-	3/4"	
		FR16-	1"	
	SS-LDC-	FL4	1/4"	General Tube Fitting
		FL6	3/8"	
		FL8	1/2"	
		FL12	3/4"	
		FL16	1"	

Male & Female Connector

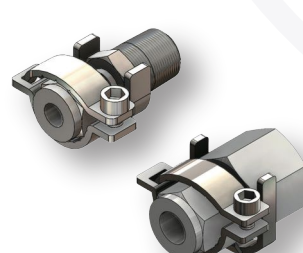
	Part Number		
	SS-LD ^{CM} _{CF} -FL□□-NS□□		
	Male : CM Female : CF	Size	Code
		1/8"	2
		1/4"	4
	Code for "□□"	3/8"	6
		1/2"	8
		3/4"	12
		1"	16

Male & Female Elbow

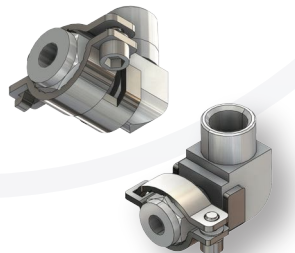
	Part Number		
	SS-LD ^{ME} _{LF} -FL□□-NS□□		
	Male : ME Female : LF	Size	Code
		1/8"	2
		1/4"	4
	Code for "□□"	3/8"	6
		1/2"	8
		3/4"	12
		1"	16

Nut Size Comparison

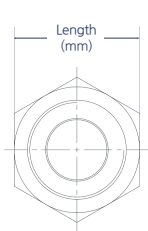
	Metal Face Seal		F-Brand (JPN)		Tube Fitting	
	Tube	Length	Tube	Length	Tube	Length
	1/8"	11.11	1/8" (3.2mm)	10.00	1/8"	11.11
	1/4"	19.10	1/4" (6.35mm)	19.00	1/4"	14.28
	1/2"	27.00	3/8" (9.52mm)	26.00	3/8"	17.46
	3/4"	38.10	3/4" (19.05mm)	38.00	1/2"	22.22
	1"	44.50			3/4"	28.57
					1"	38.10
					1-1/4"	47.63
	*** Japanese F-Brand's nuts are different in size from other brands					

Ordering Instructions

- Each part numbers exclude fittings & valves. Only for Lock Devices on photos.
- Additional Sizes are available. Please contact Jiwoo A Tech.
- Some brands have different standards for their own nut sizes. Please let us know your fitting & valve brand name.
- Our Lock Devices are protected by patents. Be careful with the use of fake items.
- If you are using **Japanese F-Brand Fittings & Valves**, you must add '-F' to the end of all part numbers. ex) SS-LDS-FR4-F

PRODUCTS

Lock Devices for Valves

General Valves

	Part Number		Tube Size	Type	Total Length Decision	
	SS-LDV-	FR4	-74*	1/4"	Metal Face Seal	*** Various sizes are available. ex) "L" : 74mm → SS-LDV-FR4-74
		FR8		3/8", 1/2"		
		FR12		3/4"		
		FR16		1"		
		FL4		1/4"	General Tube Fitting	
		FL6		3/8"		
		FL8		1/2"		
		FL12		3/4"		
		FL16		1"		

Ordering Instructions

To order Jiwoo Lock Device for Valve or Regulators, Customers should let us know the item's model number and brand name. Since valve companies have their own design and different size each other, We need to know its details to suggest the device exactly fit on it.

How To Measure Valve Length?			
Metal Face Seal Fitting Valve Length		Tube Fitting Valve Length	

Hex Ball Valve / Opened Handle Lock

	Size	Part Number
	1/4"	SS-LDHV-FL4-O
	3/8"	SS-LDHV-FL6-O
	1/2"	SS-LDHV-FL8-O
	3/4"	SS-LDHV-FL12-O
	1"	SS-LDHV-FL16-O

Hex Ball Valve / Closed Handle Lock Type 1

	Size	Part Number
	1/4"	SS-LDHV-FL4-C1

Hex Ball Valve / Closed Handle Lock Type 2

	Size	Part Number
	1/4"	SS-LDHV-FL4-C2
	3/8"	SS-LDHV-FL6-C2
	1/2"	SS-LDHV-FL8-C2
	3/4"	SS-LDHV-FL12-C2
	1"	SS-LDHV-FL16-C2

For Male Face Seal Valve

	Size	Part Number
	1/4"	SS-LDV-FR4-P-
	3/8", 1/2"	SS-LDV-FR8-P-
*** Integral / Rotatable for Pre-Cursor Canister VMB..		

For Female Face Seal Valve

	Size	Part Number
	1/4"	SS-LDV-FFR4-P-
	3/8", 1/2"	SS-LDV-FFR8-P-
*** Additional Size Available		

Special Order Products / Handle Lock Series

Regulator Handle Lock

	Size	Part Number
	**	SS-LDR-BN**
	*** Please let us know your regulator's information: 1) Brand 2) Part Numbers	

Valve Handle Lock / Type 1

	Size	Part Number
	1/4"	SS-LDV-BN***-C3

Valve Handle Lock / Type 2

	Size	Part Number
	1/4"	SS-LDV-FR4-HD
*** Padlock is not included. Refer to page 5.		

ADDITIONAL OPTIONS

LOTO Products / Additional Locking Options

Additional Locking Options

This option is intended for use additional lock on Jiwoo Lock Devices for all sizes and models.

Straps with a hole to add padlock will be provided. The hole can also be used to attach identifiable tags instead of padlocks.

It comes with a bracket cover that prevents unauthorized operators from operating valves or fittings without permission.

Examples : SS-LDS-FR16-L

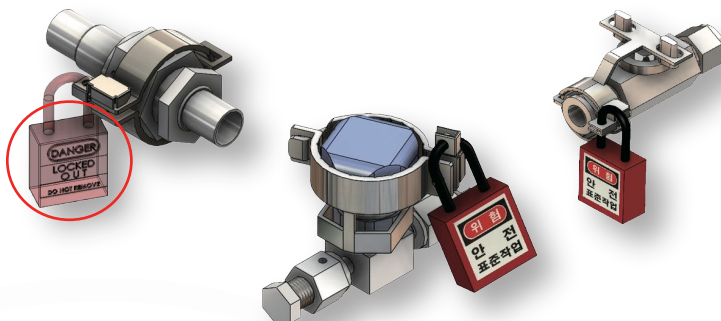

Safety Lock

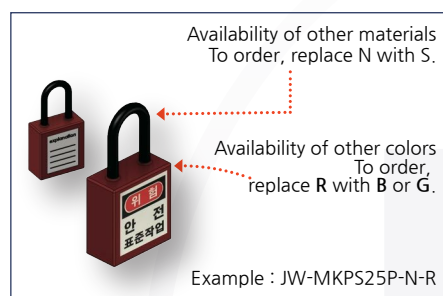

Strap with Safety Lock Holder

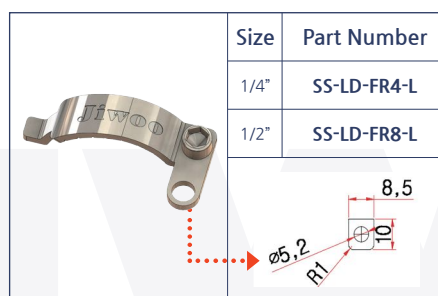

Bracket Cover

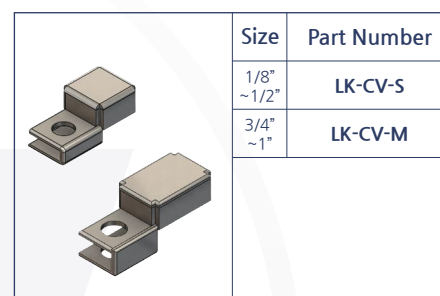

Safety Lock

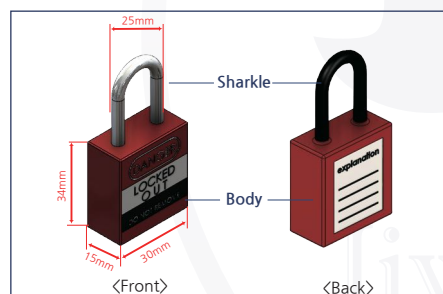

How to Order

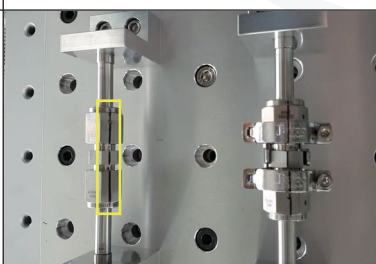
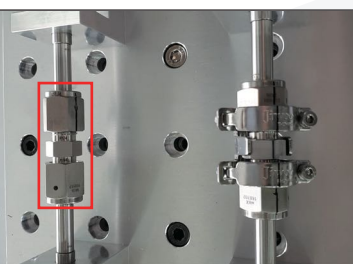

Vibration Test

Test	Set Up	Result
 Youtube Clip		
Condition	Frequency : 480 ~ 520 Hz, Acceleration : 8.5 g Time : 2 Minutes / Sweep Model : I 250 / SA4M, Manufacturer : IMV (Japan)	
Result	Unfixed Fitting : Loose in 2 minutes Fitting with Jiwoo Lock Device : Pass	

INSTRUCTION

Ordering Number Description

S		S		-	L		D		C		M		-	F		R		4		-	F		R		4		-	B		R		-	1	
Fitting/Valve Material				Product Type				Connection Type				Connection Size				Device Color				Additional Option				Special Code										
SS		For Steel Products		S		Straight Assembly		FR		Male Metal Face Seal		2		1/8" or 2mm		Nil		Standard Silver		Nil		No Option		Q1		Type 1								
PF		For PFA Products		BU		Bulkhead Type		FFR		Female Metal Face Seal		4		1/4" or 4mm		R		Red		60		Body Length for Valve ex)60mm =±60'		Q2		Type 2								
:		:		U		Union		FL		Fractional Tube Fitting		6		3/8" or 6mm		B		Blue		P		Add Plate Option		:		:								
				E		Union Elbow		ML		Metric Tube Fitting		8		1/2" or 8mm		A		Orange		S		Bonnet Strap Lock		F		Japanese F-Brand								
				T		Union Tee		NS		Male NPT		12		3/4" or 12mm		G		Green		O		Handle Locking Option / Opened Type												
				C		Union Cross		FNS		Female NPT		16		1" or 16mm		Y		Yellow		C		Handle Locking Option / Closed Type												
				CM		Male Connector		PF		PFA Fitting Ends		20		1-1/4" or 20mm		:		:		L		LOTO Safety Set (Strap & Bracket Cover_												
				ME		Male Elbow		BN		Bonnet Hold		24		1-1/2" or 24mm						HD		Round Valve Handle												
				TC		Tube Cap		:		:		32		2" or 32mm						:		:												
				V		Standard Valves						:		:																				
				HV		Hex Ball Valve																												
				:		:																												

Example

Fitting	Description	Suffix Code	Assembly	Metal Face Seal Fitting Valve Length	Tube Fitting Valve Length
	Stainless Steel Fitting	SS			
	Male Connector	LDCM			
	Tube Lok End	FL			
	1/2"	8			
	Male NPT End	NS			
	1/2"	8			

Assemble Instruction

This lock device is intended for use on General Face Seal assemblies with standard male and female nuts.

Note:

Always leak test fitting assemblies before installing a fitting Lock Device.

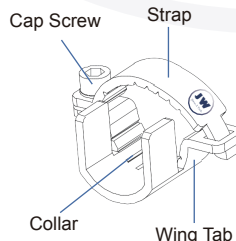

Warranty Information

Jiwoo Products are backed by Jiwoo A Tech Limited Lifetime Warranty. For a copy, visit www.jiwooat.com or contact us, sales@jiwooat.com

Tools Needed

Note: The lock device is packaged pre-assembled as shown followed photo.

- Using a 3.0mm hex key, loosen the cap screw from the lock device and disassemble collar and strap.
- Positions the collar around the fitting so the male nut fits within the parallel tabs of the collar and the female nut fits inside the wing tabs.
- Insert the tab of the strap into the slot on the collar.
- Swing the strap to meet the collar. The female nut should now be completely contained. Recheck the position of the parallel tabs and confirm they are centered with the hex flats of the male nut.
- Thread the cap screw through the large hole on the strap and into the threaded hole on the collar. Snug with hex key.

Note: Use care to ensure the screw does not become stripped due to overtightening. Assemble is now complete.

CAUTION : DO NOT MIX OR INTERCHANGE PARTS WITH THOSE OF OTHER MANUFACTURERS

EXAMPLES

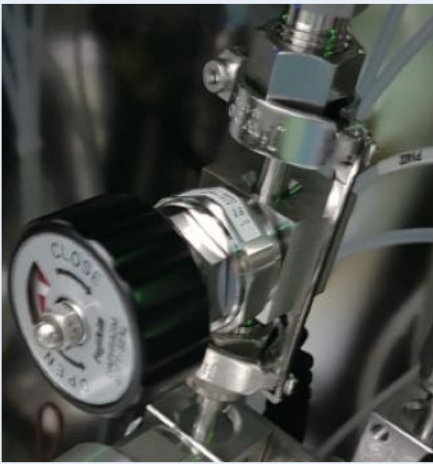
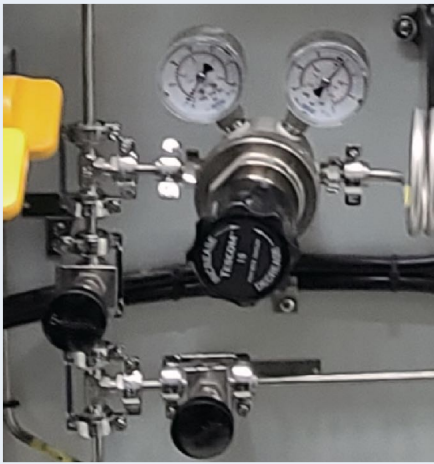

Jiwoo A-Tech. (주)지우에이텍

경기도 안양시 동안구 별말로 66, A동 1502호
Rm#1502, 66, Beolmal-Ro, Dongan-Gu, Anyang-Si, Rep.of Korea



Total Solution Provider for Fluid System

Double Lock Clamp & Fitting Lock Device

Rev.230424-R5

Office +82.2.6959.3495 | Fax +82.2.6919.1353 | email sales@jiwooat.com
www.jiwooat.com