

SG-LOK Check Valves



Samwon Green Co., Ltd.

101, Mayu-ro 20beon-gil, Siheung-si, Gyeonggi-do, Republic of Korea

Tel. 031-431-3452 / Fax. 031-431-3460

Features

- Pressure rating 3000psig (206bar) at 21°C (70°F).
- Temperature rating from 20°C (-4°F) to 190°C (374°F) with Viton seal.
- Wide choice of end connections : SG-LOK tube fittings, Male & Female NPT or ISO7/1(PT) thread.

Cleaning

- SG-LOK Check Valves are free from machining oils, loose particles and grease throughout the close cleaning process.

Testing

- Every check valve is 100% factory tested with nitrogen for cracking and reseal performance.
- The special cleaning for high purity application is available upon request.

Materials of Construction

No.	Description	Materials
1	Nut	316SS
2	Back Ferrule	316SS
3	Front Ferrule	316SS
4	Inlet Body	316SS
5	O-ring	Viton
6	Gasket	316SS
7	Poppet	316SS
8	Spring	304SS
9	Outlet Body	316SS

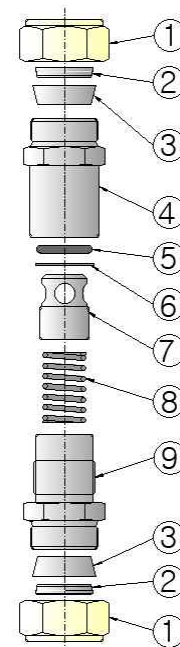

How To order

- SG-LOK Check Valves are ordered by part number as shown below.

Example:

The following part number, SG-CVU-12T-01 is designated for a check valve with 3/4" SG-LOK tube fitting, 1 psig cracking pressure.

SG-CV	U	-	12T	-	01
SG-LOK Check Valve	End Connection Type		Connection Size		Cracking Pressure

End Connection Type	T	SG-LOK Tube Fitting
	M	Male NPT or PT
	F	Female NPT or PT

Connection Size	Fractional (Inch) Tube O.D. Designation							
	Tube O.D.	inch	1/8	1/4	3/8	1/2	3/4	1
		mm	3.17	6.35	9.52	12.7	19.05	25.4
	Designator		02T	04T	06T	08T	12T	16T
	Metric Tube O.D. Designation							
	Tube O.D.	mm	3	6	8	10	12	25
	Designator		03M	06M	08M	10M	12M	25M
	Pipe Size Designation (NPT or PT)							
	Pipe Size		1/8	1/4	3/8	1/2	3/4	1
	Designator		02N/R	04N/R	06N/R	08N/R	12N/R	16N/R

Cracking Pressure	psig	1/3	1	3	10	25	100
	Designator	1/3	01	03	10	25	100

Ordering Information & Dimension

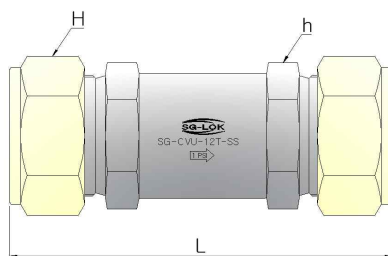

Part Number	End Connections		Cv	Dimensions (mm)		
	Inlet	Outlet		L	H	h
U-02T	1/8" SG-LOK		0.16	54.5	11.11	15.87
U-04T	1/4" SG-LOK		0.47	59	14.28	
U-06MT	6mm SG-LOK			59	-	
F-02N	1/8" Female NPT			46.5		
M-02N	1/8" Male NPT			47.3		
M-04N	1/4" Male NPT			52.6		
F-04N	1/4" Female NPT		1.48	54.5	-	19.05
U-06T	3/8" SG-LOK			80.4	17.46	
U-10MT	10mm SG-LOK			81.7	19.05	
M-06N	3/8" Male NPT			70.6	-	
U-08T	1/2" SG-LOK		1.7	85.6	22.22	22.22
U-12MT	12mm SG-LOK			86	-	
F-06N	3/8" Female NPT			76.2		26.98
M-08N	1/2" Male NPT			83		
F-08N	1/2" Female NPT			83		
U-10T	5/8" SG-LOK		2.6	88	25.4	28.58
F-08N	1/2" Female NPT			91.2	-	
U-12T	3/4" SG-LOK		5.2	91.8	28.58	31.75
F-12N	3/4" Female NPT			87.5	-	
M-12N	3/4" Male NPT			86		
U-16T	1" SG-LOK		8	106.3	38.1	34.93
M-16N	1" Male NPT			102.3	-	
F-16N	1" Female NPT			123		41.28

Female ISO7/1 Tapered Threads (PT) are available for all fractional sizes of SG-CV series valves. Add "R" as a suffix instead of "N".

Dimensions are for reference only and are subject to change without prior notice.